

P.C.B. LAYOUT

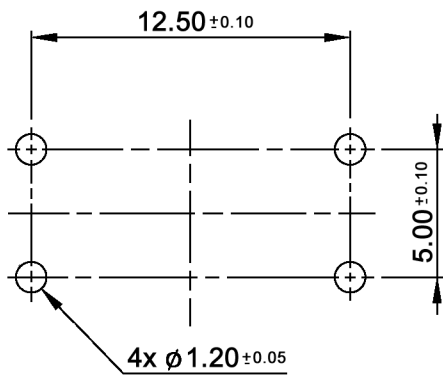

CIRCUIT DIAGRAM

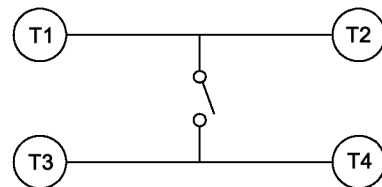

Compliance: RohS II (2011/65/EU)

Tolerances: ±0.20mm	Date	Name
	07/11	dr
Rename	08/14	dr
Modifications	Date	Name

knitter-switch

TS 24 x

30 24 03

Page

1/2

Specifications:

Contact rating: 50mA, 12V DC
 Contact resistance: 100mOhm max.
 Insulation resistance: 100MOhm min. at 500V DC
 Dielectric strength: 250V, 50Hz for the duration of 1 minute
 Operating temperature: -40°C to +85°C
 Soldering conditions: hand-soldering: max.: 320°C, 2sec., 30W
 auto-soldering: max.: 260°C, 5sec.
 Travel: 0.35 +/-0.1mm
 Mounting: on pc-board
 Material: Contacts: phosphor bronze, silver plated
 Terminals: PC terminals, brass, silver plated

x	Operating force (gf)	Stem color	Electrical life
N	160 +/-50	brown	200 000 cycles
R	260 +/-50	red	100 000 cycles
S	320 +/-80	salmon	100 000 cycles
Y	520 +/-130	yellow	100 000 cycles

Compliance: RohS II (2011/65/EU)

Tolerances: ±0.20mm	Date	Name	TS 24 x	30 24 03	Page
	07/11	dr			
	knitter-switch				
Modifications	Date	Name			2/2